

**MATERIAL(S) :**

Housing body:  
Brass Alloy, UNS No. C36000 PER ASTM B-16,  
Top body:  
6061-T651 Aluminum Alloy

Core HC2 connector:  
Spring Pin:  
BeCu Alloy/Brass Alloy C3604B/ Phosphor Bronze  
Ground Slider & Nut:  
Brass Alloy C3604B  
Insulator: TPX / PTFE  
Dielectric: Ultem/ TPX  
Spring: Music Wire  
Dowel Pin, Screw & Clip: Stainless Steel.

Cable: 16507086-04

**ELECTRICAL(S) :**

Impedance: 50 Ohms Nominal  
Frequency Range: DC to 26 GHz  
VSWR: 1.25:1 DC to 26 GHz  
Insertion Loss:  
1.60 dB DC to 26 GHz  
Phase: Matched In Pairs @ 2.0 pS.

Working Voltage: 335 Vrms max @ Sea Level  
Test Voltage: 500 Vrms  
Insulation Resistance: 5000 MegOhms min.  
Contact Current: 1A DC max.  
Contact Resistance:  
Center Contact: 100 m Ω

**MECHANICAL(S) :**

Mating Characteristics:  
SMA Interface per MIL-STD-348  
CORE HC2 Interface per CarlisleIT  
Force to Engage:  
SMA: 2 In-lbs max  
CoreHC2 (Individual): .5 Lbs Typ.  
Connector Durability:  
SMA: 500 Cycles @ 12 cycles/min. max  
CoreHC2: 20,000 Cycles @ 12 cycles/min. max  
Permeability: Less than 2.0 mu.  
Coupling Proof Torque:  
SMA: 15 in-lb

**ENVIRONMENTAL(S) :**

Temperature Range: -65°C to +150°C  
Thermal Shock:  
MIL-STD-202, Method 107, Test Condition F  
Moisture Resistance:  
MIL-STD-202, Method 106, Insulation resistance  
at least 200 MegaOhms within 5 minutes after  
removal from humidity.  
Corrosion:  
MIL-STD-202, Method 101, Test Condition C  
Vibration:  
MIL-STD-202, Method 204, Test Condition A,  
except 5g Peak  
Shock:  
MIL-STD-202, Method 213, Test Condition I,  
except 10g Peak

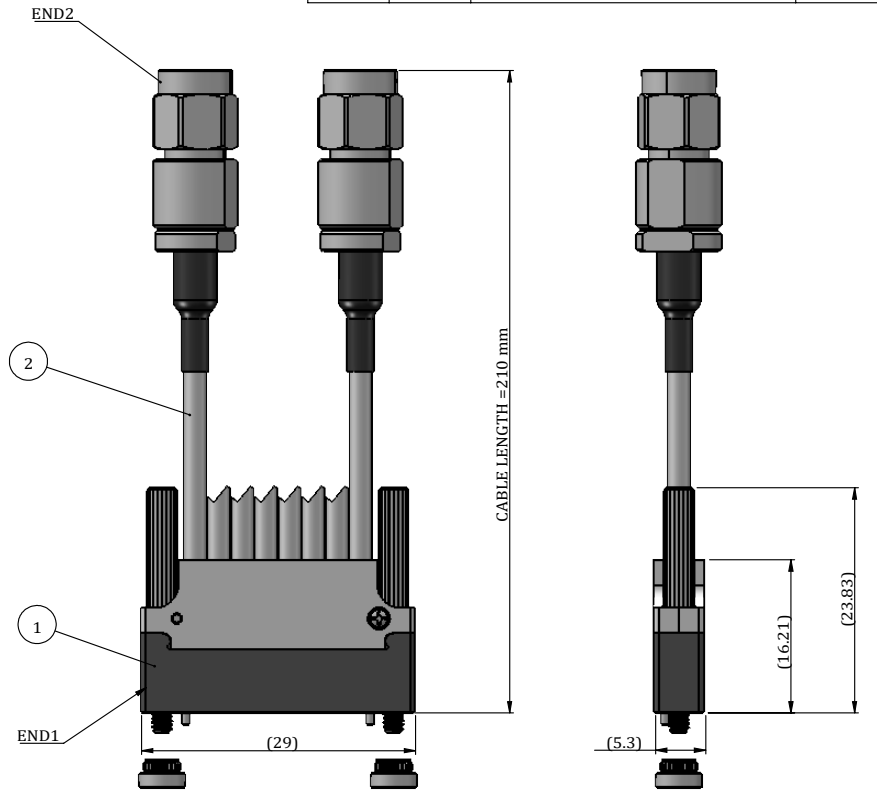
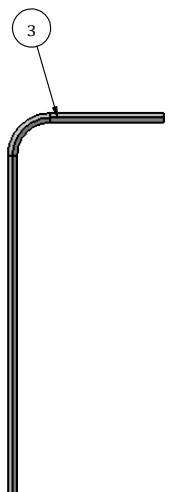

PART NUMBER	CABLE LENGTH
TM40-0157-00	210mm
TM40-0157-01	400mm

**NOTE(S):**

- 1 , NUTS AND HEX WRENCH TO BE PACKED AND SHIPPED UN-ASSEMBLED WITH FULLY ASSEMBLED CABLE ASSEMBLY.
- 2 , NUTS TO BE PRESS FIT INTO PCB ON CUSTOMER SIDE .
- 3 , CUSTOMER NEED TO USE THUMB SCREW TO LOCK CONNECTOR WITH PCB TIGHTLY .
- 4 , NOMINAL TOLERANCE REFER TO ISO2768-F.
- 5 , CABLE LENGTH TOLERANCE REFER TO ISO2768-V, AND TOLERANCE VALUE MULTIPLIED BY 2.
- 6 , THIS CABLE ASSEMBLY WILL USE STRANDED CENTER CONDUCTOR, AND BLACK FLEXIBLE PVC JACKET.
- 7 , CAPS PROVIDED ON END 1 TM12-0108-00 AND END 2 TM12-0102-00 NOT SHOWN.
- 8 , PEM NUTS PROVIDED FOR MOUTING TO PCB ARE C6635-2 FOR 0.062"1.57mm PCB THICKNESS.

ITEM	PART NUMBER	DESCRIPTION	MATERIAL	QTY
5	TM12-0102-00	PROTECTIVE CAP	N/A	8
4	TM12-0108-00	PROTECTIVE CAP CORE HC 8 POS STRAIGHT	N/A	1
3	TM15-0067-00	HEX WRENCH FOR HC2 , 0.05" , 1.27mm	N/A	1
2	TM7S2-H2S-2MS-XXXX	CoreHC 2.5mm TO SMA(M) ON .078 CABLE , XXCM	N/A	8
1	TM7S-SH28R	METALLIC HOUSING BUCKET	N/A	1

★ KEY DIMENSION NEED 100% INSPECTION (XX) REF. DIMENSION FOR REF. ONLY	DRAWN: Falcon	<b>CARLISLE</b> INTERCONNECT TECHNOLOGIES	Dongguan City,Guangdong P.R. China 523533		
	CHECKED:		MATERIAL:	PROJECT NAME:	
APPROVED:		PART NUMBER: TM40-0157-0X	CoreHC 078 Assy, 1xRow HC2 8CH to SMA(M), XXcm, Metallic Housing		
INFORMATION CONTAINED ON THIS DRAWING IS CONFIDENTIAL AND MAY ALSO CONTAIN PROPRIETARY CARLISLE/CUSTOMER INFORMATION. DRAWING CONTENT IS ONLY INTENDE FOR USE OF THE ABOVE CUSTOMER IF YOU ARE NOT THE INTENDED RECIPIENT OR AUTHORIZED EMPLOYEE OF ABOVE COMPANY NAME, YOU ARE HEREBY NOTIFIED ANY USE, DUPLICATION, RECONSTRUCTION, OR DISTRIBUTION OF DRAWING INFORMATION IS STRICTLY PROHIBITTED.		SIZE A4		PART NAME: FINISHED GOODS ASSY	REVISION: F
		SCALE 3:2		DO NOT SCALE DRAWING	
				SHEET 1 OF 1	



ISO2768-V (mm)					
6~30	30-120	120~400	400~1K	1K~2K	>2K
±1	±1.5	±2.5	±4	±6	±8
ISO2768-F (mm)					
0.5~3	3~6	6~30	30~120	120~400	400~1000
±0.05	±0.05	±0.1	±0.1	±0.2	±0.3