

REVISION HISTORY					
ECO	REV	DESCRIPTION	DRAWN BY	APPROVAL	DATE
-	A	INITIAL RELEASE	K FISHER	S MURPHY	JAN-23-19
-	F	ADD EXT. CONN. DIMS	K FISHER	EMAD S	APR-24-20

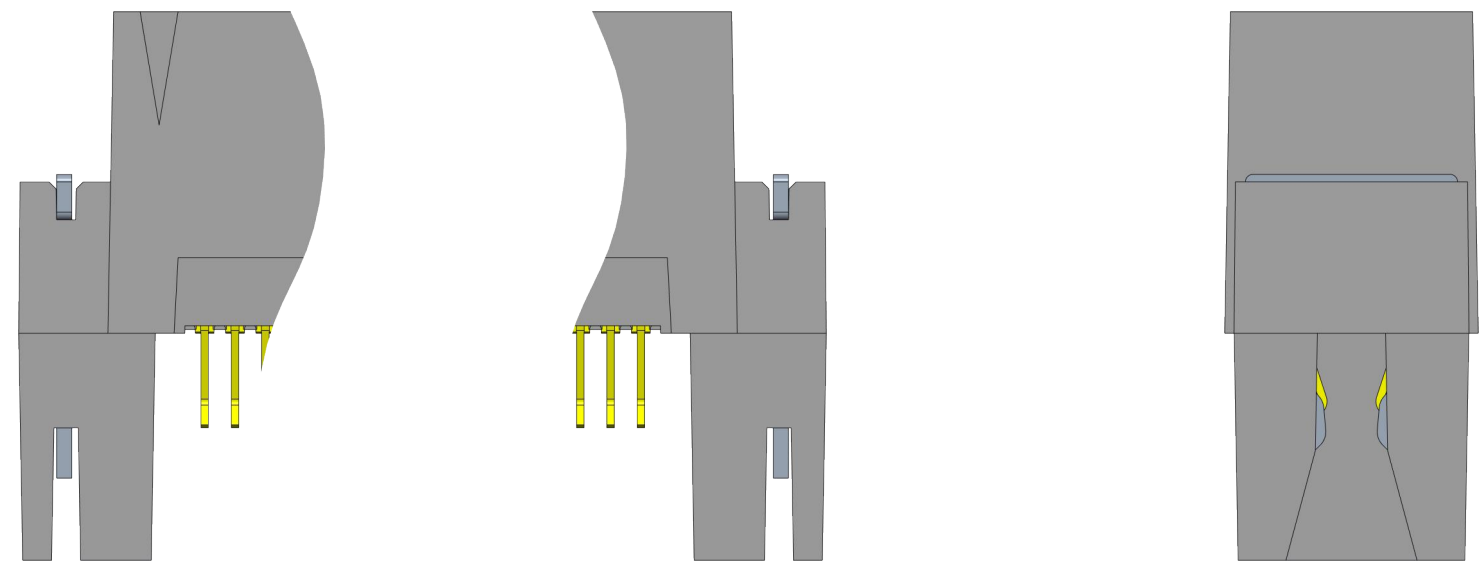
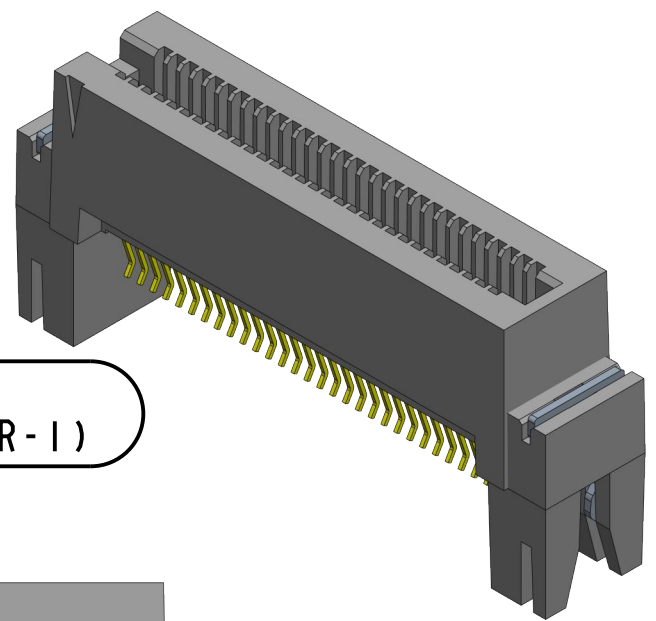
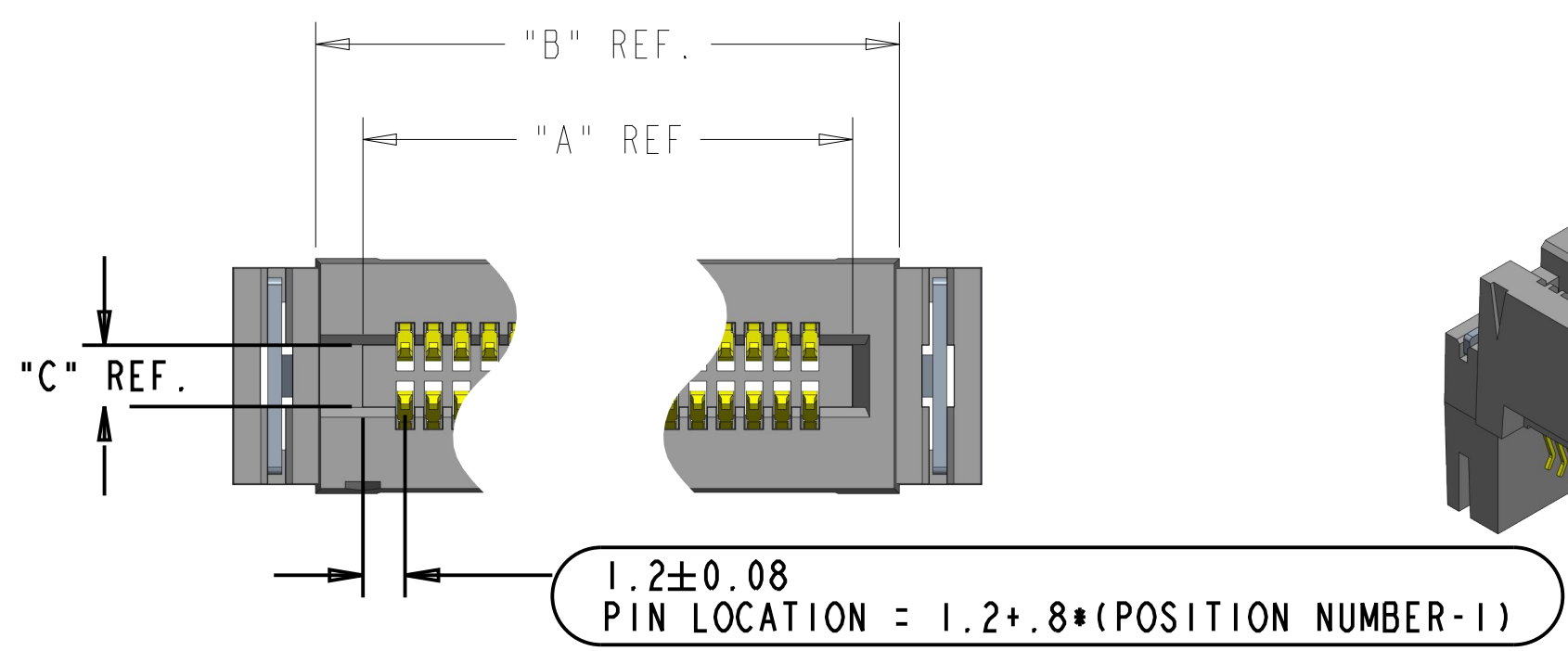

MBB-XX-XX-XX-30-XX

MBB = BLACK MAMBA BOARD MOUNT CONNECTOR

MOUNTING TYPE: _____
 VERTICAL MOUNT=VM
 EDGE MOUNT= EM

OF POSITIONS _____
 EX: 10, 20 ,30

PCB THICKNESS _____
 62 = 0.062" NOMINAL
 93 = 0.093" NOMINAL

CONTACT GOLD PLATING THICKNESS _____
 30 = 30 MICRO INCH MIN.

ADTL. MOUNTING AIDES: _____
 00 = ALIGNMENT PINS
 01 = NO ALIGNMENT PINS, NO SOLDER TAB
 ST = SOLDER TAB

MBB PART NUMBER
MBB-VM-10-62-30-00
MBB-VM-10-62-30-01
MBB-VM-10-62-30-ST
MBB-EM-10-62-30-ST
MBB-VM-10-93-30-00
MBB-VM-10-93-30-01
MBB-VM-10-93-30-ST
MBB-EM-10-93-30-ST
MBB-VM-20-62-30-00
MBB-VM-20-62-30-01
MBB-VM-20-62-30-ST
MBB-EM-20-62-30-ST
MBB-VM-20-93-30-00
MBB-VM-20-93-30-01
MBB-VM-20-93-30-ST
MBB-EM-20-93-30-ST
MBB-VM-30-62-30-00
MBB-VM-30-62-30-01
MBB-VM-30-62-30-ST
MBB-EM-30-62-30-ST
MBB-VM-30-93-30-00
MBB-VM-30-93-30-01
MBB-VM-30-93-30-ST
MBB-EM-30-93-30-ST

PCB Thickness	# Positions	"A"	"B"	"C"	"D"	"H"	"M"	"S"	"T"
62	10	9.6	12.3	1.75	3.0	1.49	14.6	12.3	17
62	20	17.6	20.3	1.75	3.0	1.49	22.6	20.3	25
62	30	25.6	28.3	1.75	3.0	1.49	30.6	28.3	33
93	10	9.6	12.3	2.63	3.78	2.24	14.6	12.3	17
93	20	17.6	20.3	2.63	3.78	2.24	22.6	20.3	25
93	30	25.6	28.3	2.63	3.78	2.24	30.6	28.3	33

NOTES: UNLESS OTHERWISE SPECIFIED
 1. DIMENSIONING AND TOLERANCES PER ASME Y14.5 2010
 2. DIMENSIONS CONTAINED WITHIN \varnothing ARE CRITICAL TO THE FUNCTION OF THE PART/ASSEMBLY

THE INFORMATION CONTAINED HEREIN IS PROPRIETARY TO CARLISLE, INC. AND SHALL IN NO WAY BE REPRODUCED OR DISCLOSED IN WHOLE OR IN PART OR USED FOR ANY DESIGN OR MANUFACTURE EXCEPT WHEN SUCH USER POSSESSES DIRECT, WRITTEN AUTHORIZATION FROM CARLISLE, INC.



<small>UNLESS OTHERWISE SPECIFIED ALL DIMENSIONS ARE IN MILLIMETERS. TOLERANCES ARE: X.X +/- 0.1 X.XX +/- 0.05 ANG +/- .1</small>	THIRD ANGLE PROJECTION		 www.carlisleit.com	
	CHECKED: S MURPHY Jan-23-19 DESIGNED: K FISHER Jun-20-18 PRODUCT: E SOUBH Jan-23-19 QUALITY: R BEDIENT Jan-23-19 MFG: K FISHER Jan-23-18		TITLE MBB CARD EDGE CONNECTOR	SIZE C
DO NOT SCALE DRAWING	SCALE 5.000	DRAWING NBR 1 of 6	REV F	

MOUNTING TYPE:
EDGE MOUNT = EM

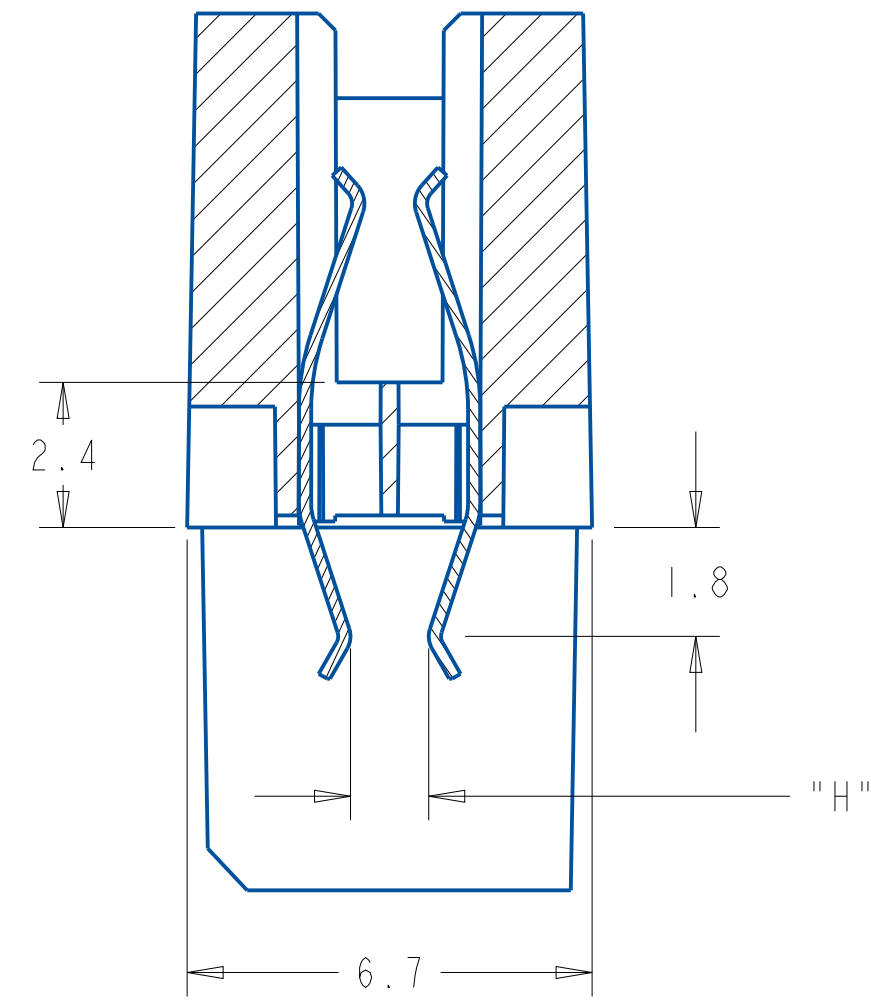
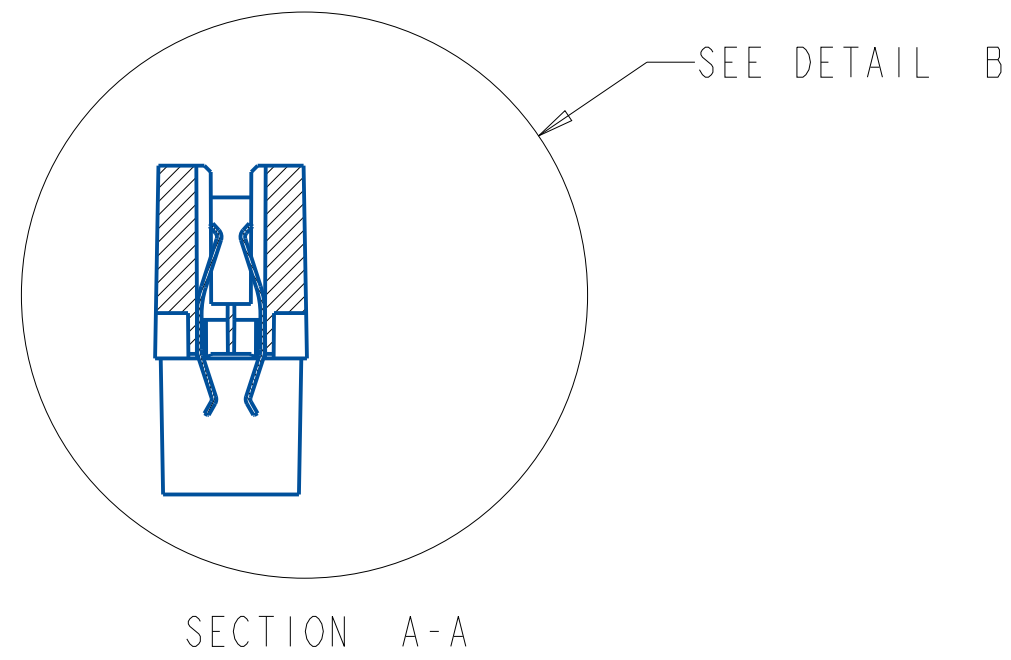
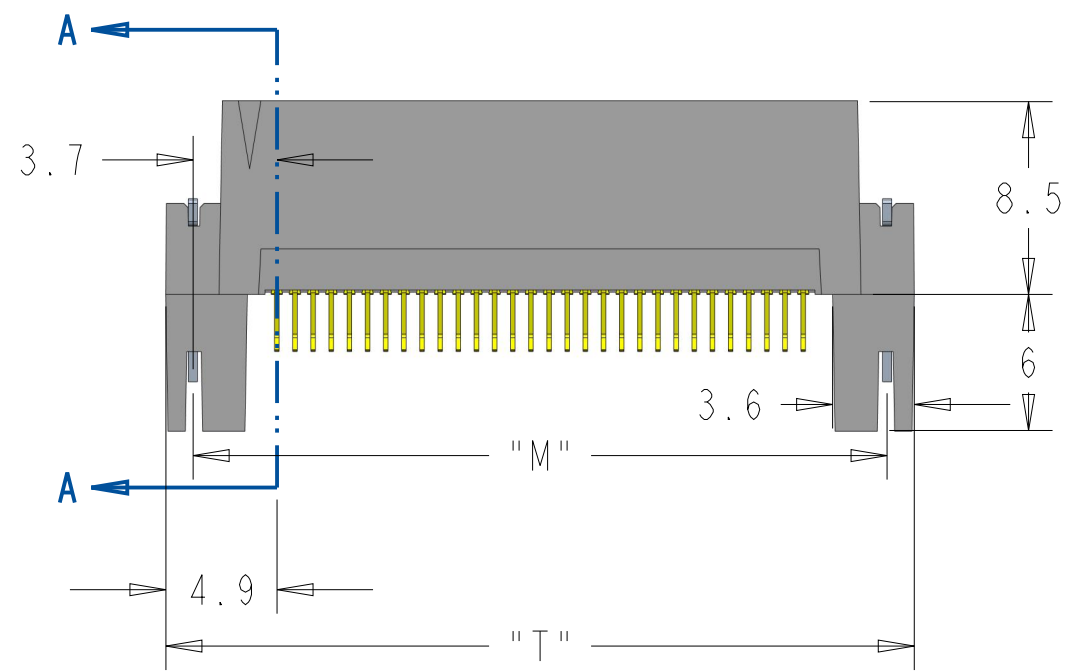

DETAIL B
SCALE 8.000

MOUNTING TYPE:
VERTICAL MOUNT = VM

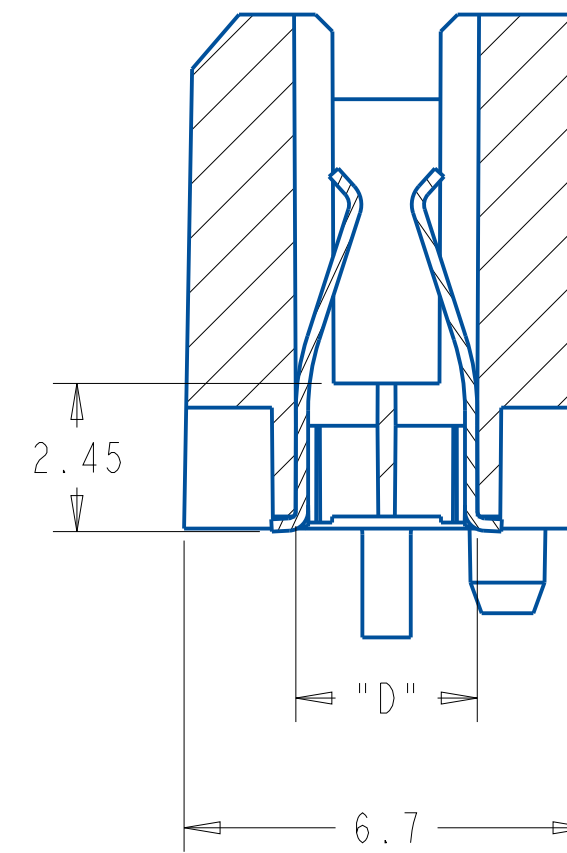
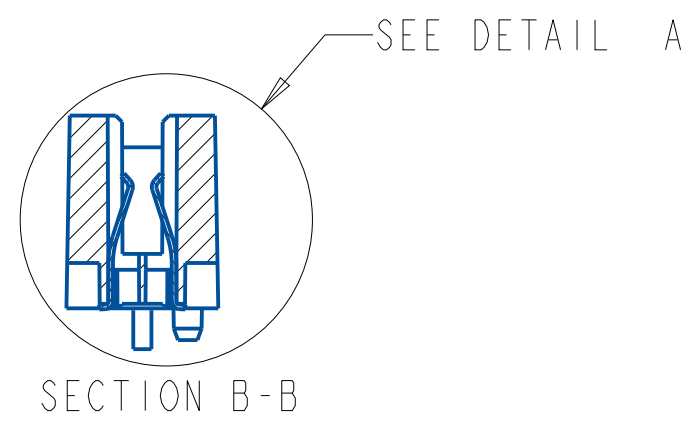
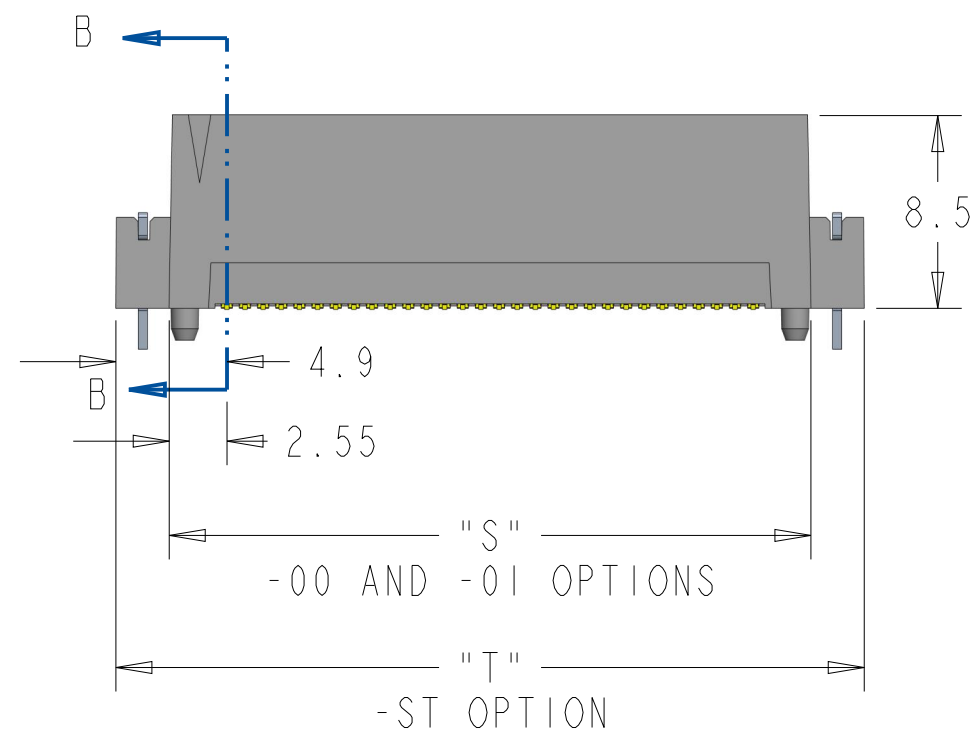

DETAIL A
SCALE 8.000

THE INFORMATION CONTAINED HEREIN IS PROPRIETARY TO CARLISLE, INC. AND SHALL IN NO WAY BE REPRODUCED OR DISCLOSED IN WHOLE OR IN PART OR USED FOR ANY DESIGN OR MANUFACTURE EXCEPT WHEN SUCH USER POSSESSES DIRECT, WRITTEN AUTHORIZATION FROM CARLISLE, INC.



TITLE
MBB CARD EDGE CONNECTOR

SIZE	CAGE CODE	CARLISLE NUMBER	REV
C	7M294	MBB-XM-XX-XX-30-XX	F
SCALE	3.000	DRAWING NBR	2 of 6

D

D

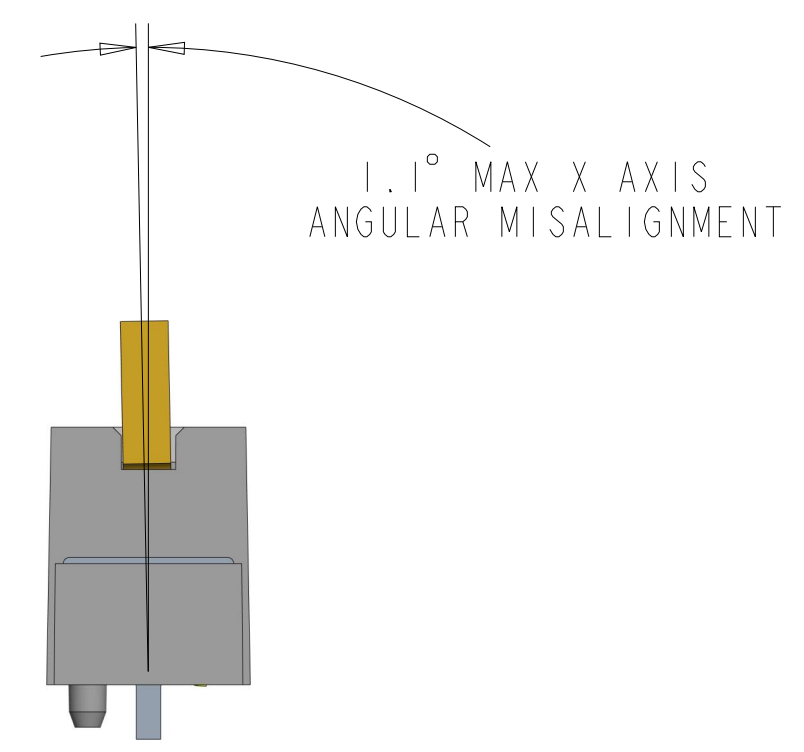
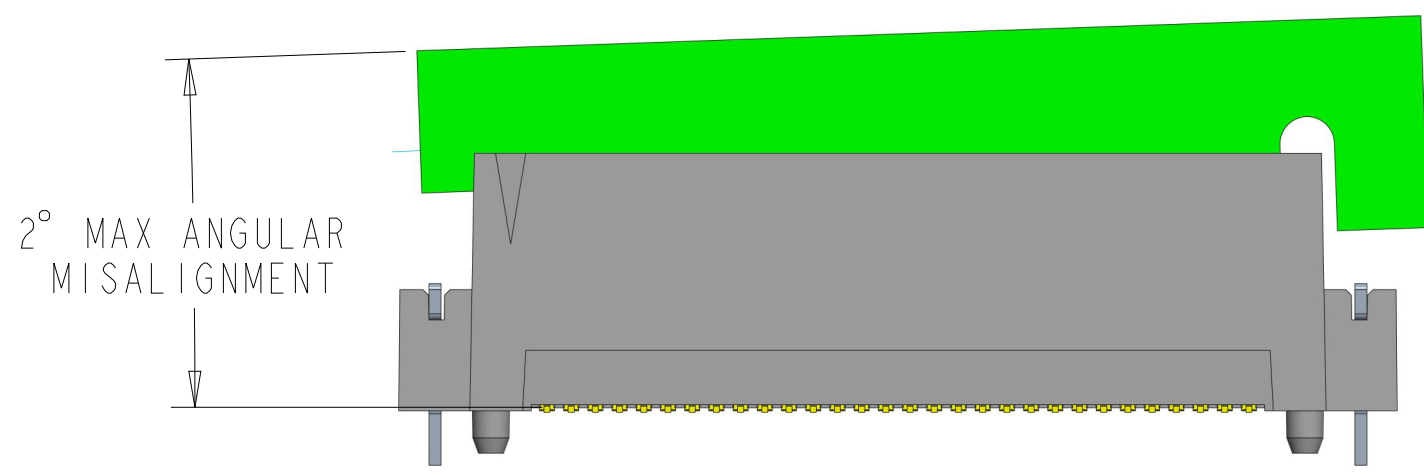

C

C

B

B

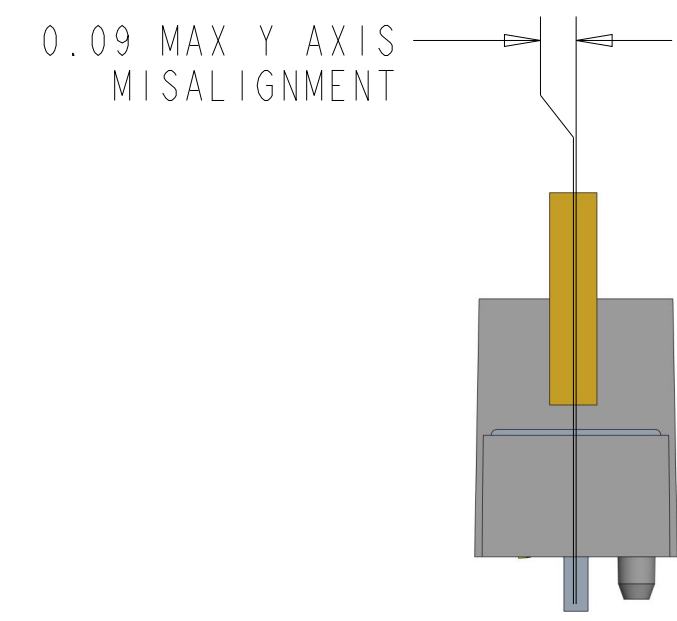
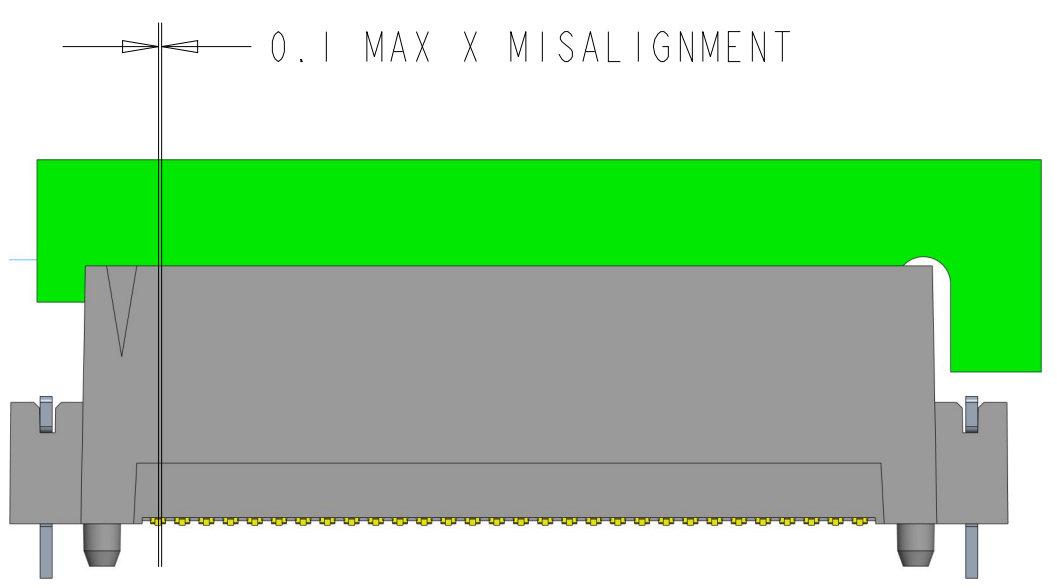

A

A

THE INFORMATION CONTAINED HEREIN IS PROPRIETARY TO CARLISLE, INC. AND SHALL IN NO WAY BE REPRODUCED OR DISCLOSED IN WHOLE OR IN PART OR USED FOR ANY DESIGN OR MANUFACTURE EXCEPT WHEN SUCH USER POSSESSES DIRECT, WRITTEN AUTHORIZATION FROM CARLISLE, INC.



CARLISLE <small>INTERCONNECT TECHNOLOGIES</small> www.carlisleit.com			
TITLE MBB ALIGNMENT			
SIZE	CAGE CODE	CARLISLE NUMBER	REV
C	7M294	MBB-XM-XX-XX-30-XX	F
SCALE	DRAWING NBR		3 of 6
1.000			

PCB THICKNESS	MAX.	MIN.
1.57 (0.062")	1.73(0.0681")	1.46 (0.0575")
2.36 (0.093")	2.51 (0.0988")	2.32 (0.0913")

TABLE 2		
# POSITIONS	"J"	"K"
10	7.2	9.40
20	15.2	17.40
30	23.2	25.40

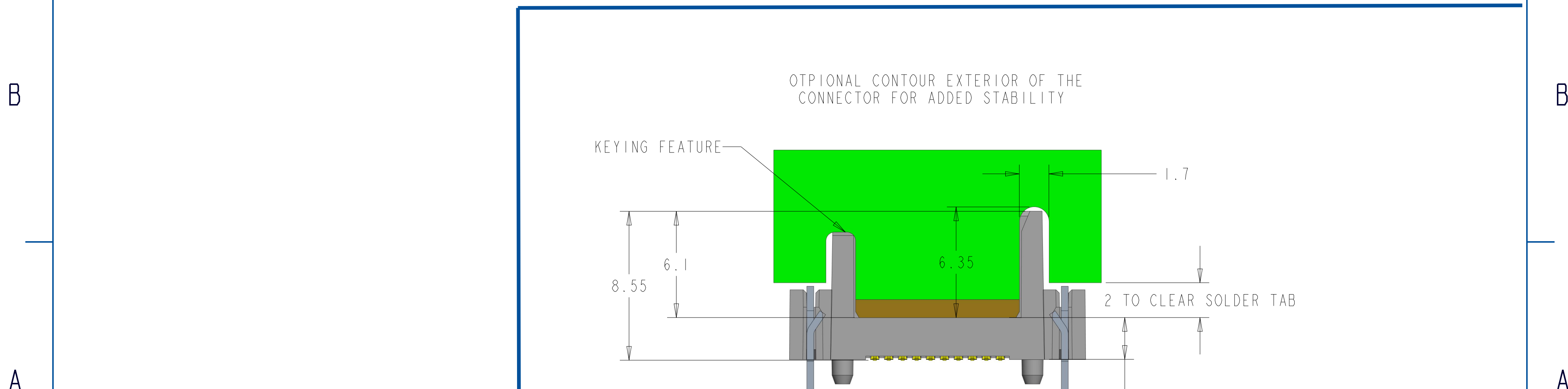
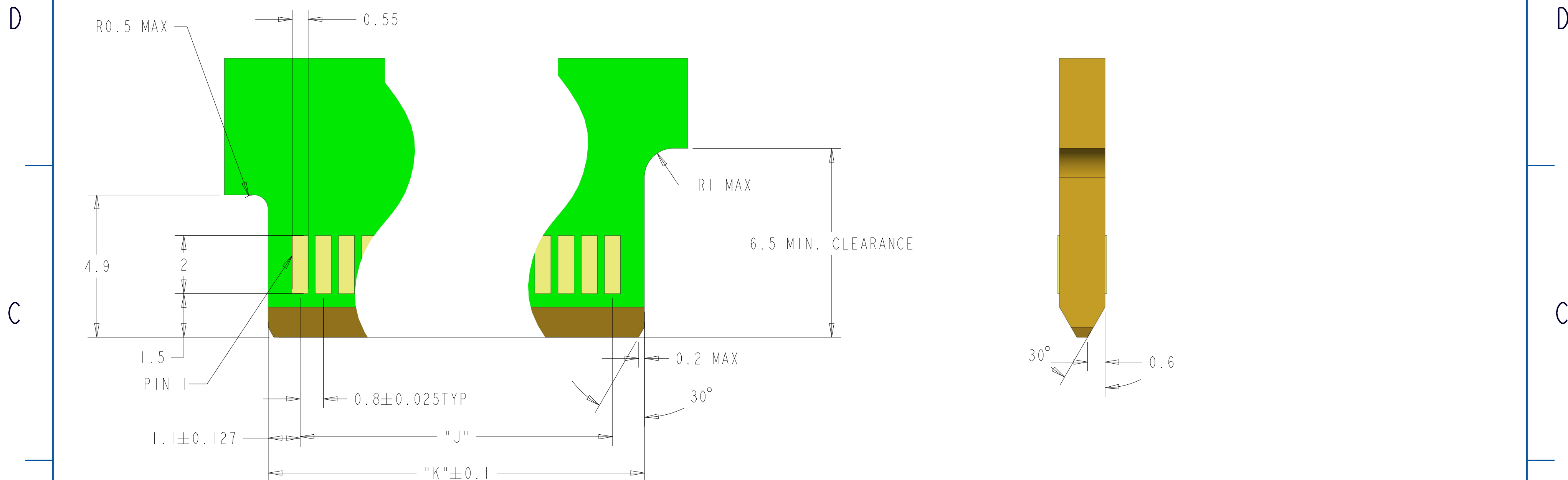

THE INFORMATION CONTAINED HEREIN IS PROPRIETARY TO CARLISLE, INC. AND SHALL IN NO WAY BE REPRODUCED OR DISCLOSED IN WHOLE OR IN PART OR USED FOR ANY DESIGN OR MANUFACTURE EXCEPT WHEN SUCH USER POSSESSES DIRECT, WRITTEN AUTHORIZATION FROM CARLISLE, INC.



CARLISLE
INTERCONNECT TECHNOLOGIES
www.carlisleit.com

TITLE
MBB PADDLE CARD (AIC)

SIZE C	CAGE CODE 7M294	CARLISLE NUMBER MBB-XM-XX-XX-30-XX	REV F
SCALE 10.000	DRAWING NBR		4 of 6

PCB THICKNESS	MAX	MIN
1.57 (0.062")	1.73(0.0681")	1.46 (0.0575")
2.36 (0.093")	2.51 (0.0988")	2.32 (0.0913")

TABLE 3		
# POSITIONS	"L"	"M"
10	7.2	14.6
20	15.2	22.6
30	23.2	30.6

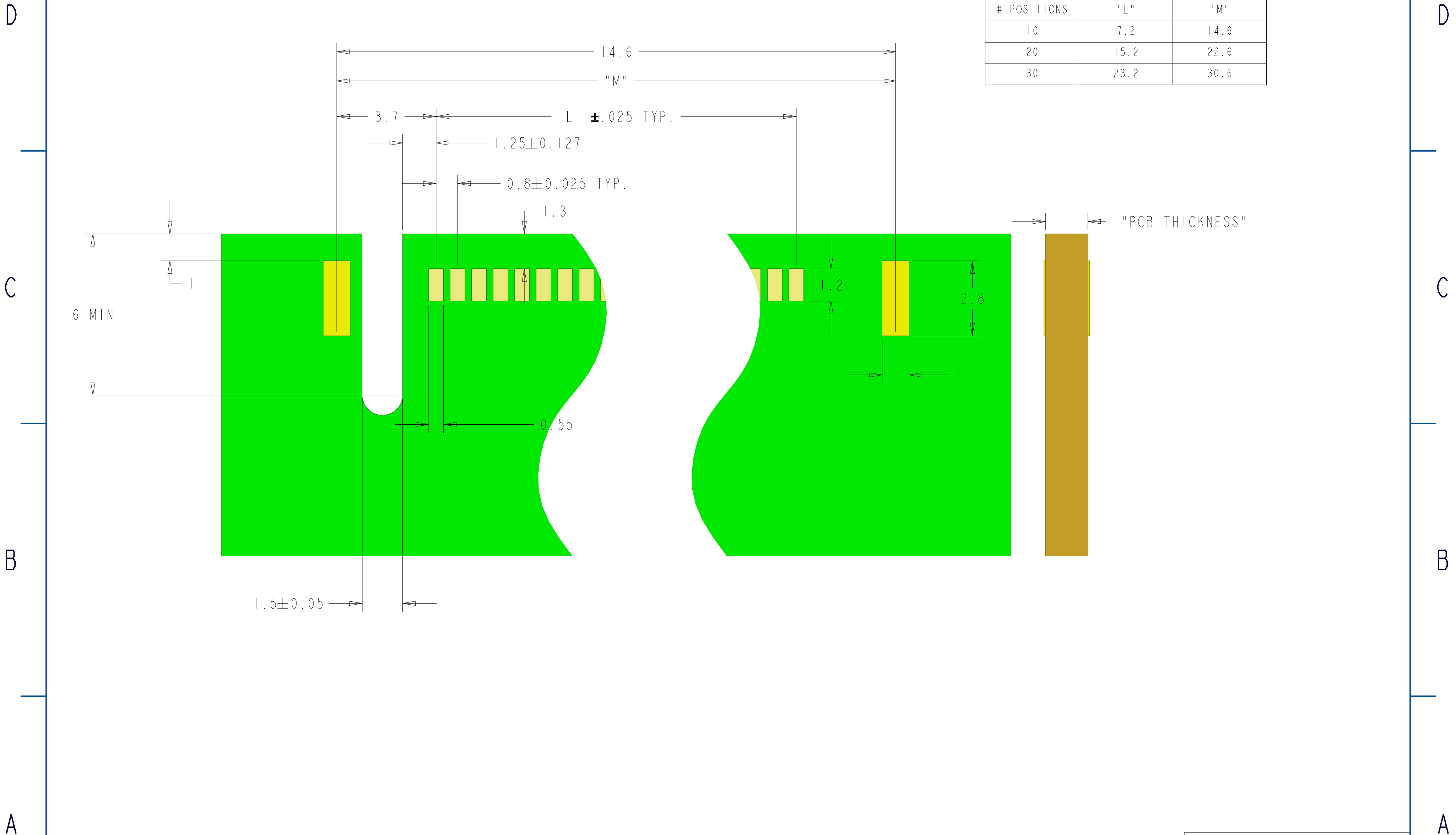

THE INFORMATION CONTAINED HEREIN IS PROPRIETARY TO CARLISLE, INC. AND SHALL IN NO WAY BE REPRODUCED OR DISCLOSED IN WHOLE OR IN PART OR USED FOR ANY DESIGN OR MANUFACTURE EXCEPT WHEN SUCH USER POSSESSES DIRECT, WRITTEN AUTHORIZATION FROM CARLISLE, INC.



CARLISLE
INTERCONNECT TECHNOLOGIES
www.carlisleit.com

TITLE
MBB EM BOARD

SIZE C	CAGE CODE 7M294	CARLISLE NUMBER MBB-XM-XX-XX-30-XX	REV F
SCALE 10.000	DRAWING NBR		5 of 6

TABLE 4					
Paddle Card (AIC) Thickness	# POSITIONS	"N"	"P"	"Q" -ST OPOTION ONLY	"R"
62	10	7.2	10.9	14.6	2.1
62	20	15.2	18.9	22.6	2.1
62	30	23.2	26.9	30.6	2.1
93	10	7.2	10.9	14.6	2.9
93	20	15.2	18.9	22.6	2.9
93	30	23.2	26.9	30.6	2.9

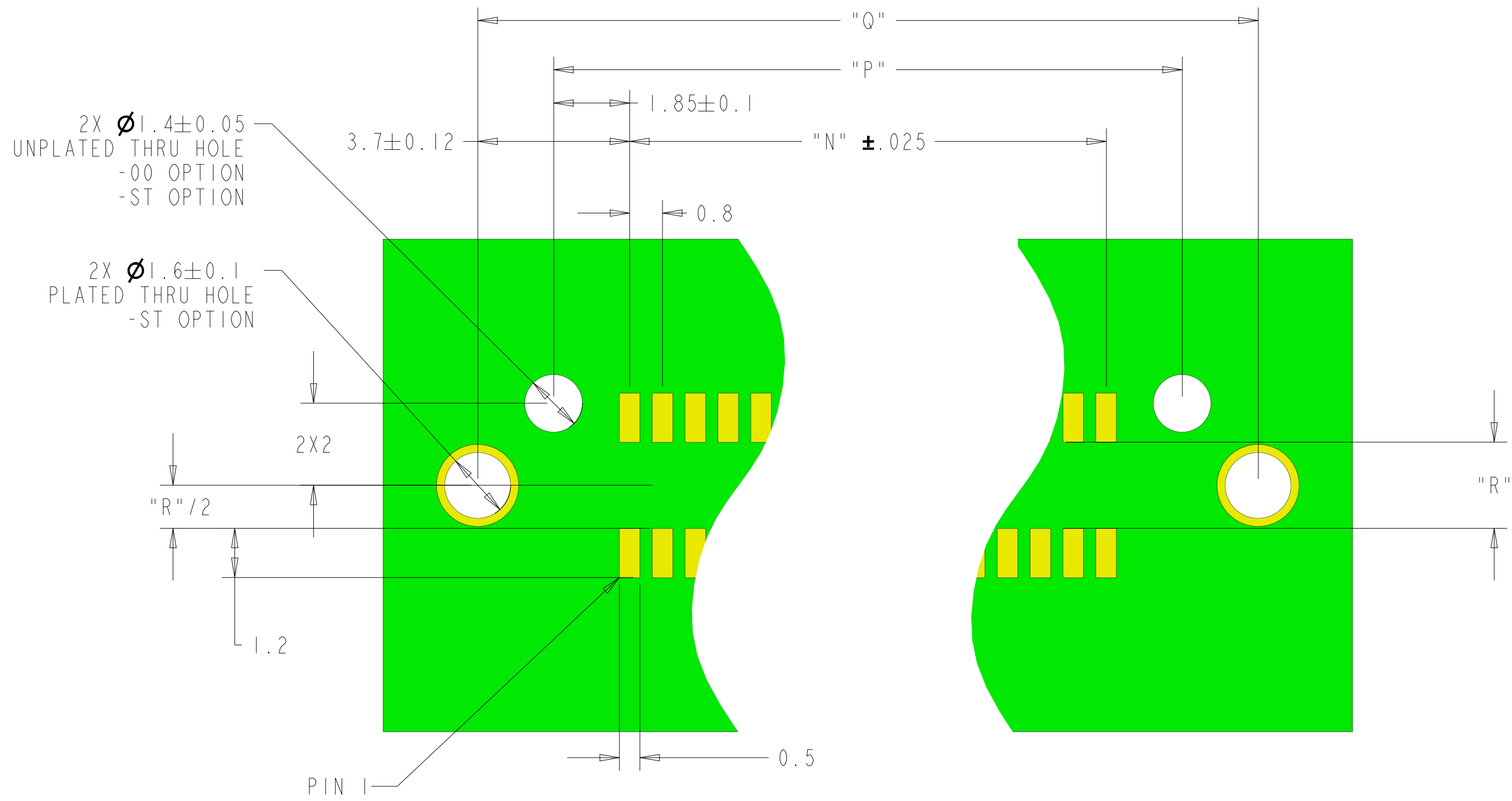

THE INFORMATION CONTAINED HEREIN IS PROPRIETARY TO CARLISLE, INC. AND SHALL IN NO WAY BE REPRODUCED OR DISCLOSED IN WHOLE OR IN PART OR USED FOR ANY DESIGN OR MANUFACTURE EXCEPT WHEN SUCH USER POSSESSES DIRECT, WRITTEN AUTHORIZATION FROM CARLISLE, INC.



CARLISLE
INTERCONNECT TECHNOLOGIES
www.carlisleit.com

TITLE
MBB VM BOARD

SIZE C	CAGE CODE 7M294	CARLISLE NUMBER MBB-XM-XX-XX-30-XX	REV F
SCALE 10.000	DRAWING NBR		6 of 6